

## Selecting Elements to Change Status

From either viewing mode, you can use the iPad viewing screen to select elements and change status.

In **“AR Mode”** the model is synced to a marker on the jobsite and you will look through the iPad using the viewing window to see the overlay of CAD elements vs. the installed field elements to change status.

In **“Free-flight Mode”** you will look at the iPad screen at any angle in the field or off-site as a reference to view and identify status.

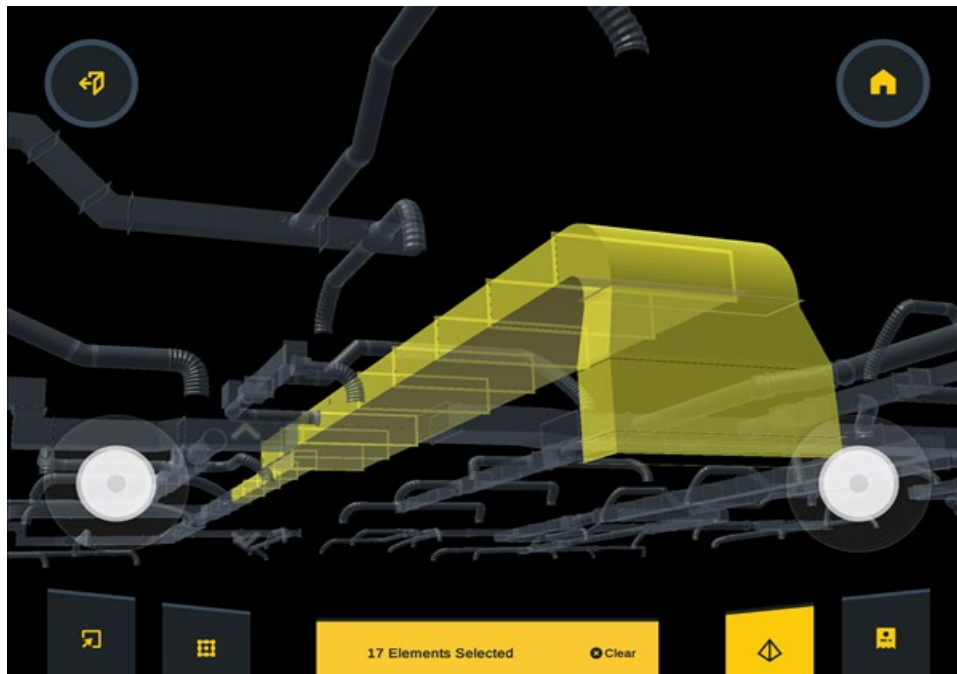

## Selecting elements from the model to modify status.

- ➔ Select the model elements from the screen with your finger to select/deselect elements in AR model.

Elements will change color when selected and show up on the “Elements Selected” count on the bottom of the screen.

### Selection options:

- **Option 1:** Single Pick: Default option: Select each model element individually by picking them with your finger.
- **Option 2:** Linear Selection: Default option: Select multiple elements at a time by dragging your finger along the model elements for a continuous selection.
- **Option 3:** Lasso Box: Select the “Selection Tools” button on the lower left of the screen to change the “Linear Selection” option to “Lasso Box”. This allows you to select multiple elements with a selection window. 

**Note:** All items will be selected in window box if more than 50% of the element is within the window outline.

To get back to “Linear Selection”, use the “Selection Tools” button to change the selection setting. 

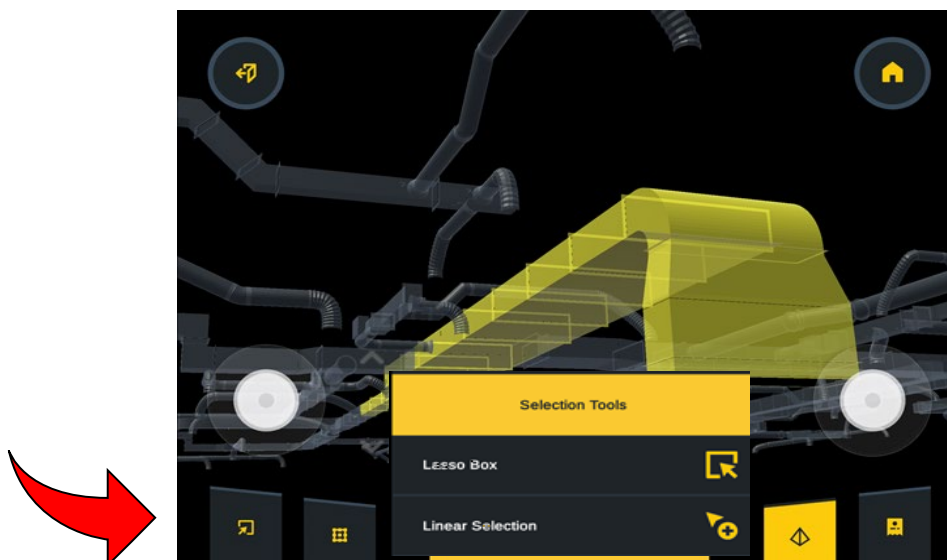

- ➔ Once all the elements are selected as a group to change their status, tap on the “xx Elements Selected” button on the bottom to open the “Selection Setting Options” dialogue box.
- ➔ Tap on “00 Elements Selected” text option in the dialogue box to change element status

**Note:** By default, when the model is first opened, all elements are shown as “Not Installed” and are colored grey.

### **Extended Status**

If additional “Extended Status” options exist, the list will scroll up from the bottom of the screen.

### **Element status options:**

1. “Set to Installed”: Elements turn Green.
  - a. All elements in this setting will be identified as installed.
2. “Set to Needs Rework”: Elements turn Yellow.
  - a. All elements in this setting will be identified as needs rework due to a field or design change.
3. “Extended Status”: Element colors assigned by the software
  - a. All elements in this setting will be defined by the custom user defined status options
  - b. If extended statuses are used, multiple statuses can be selected at once and use the “Apply” button to apply the status to the elements.

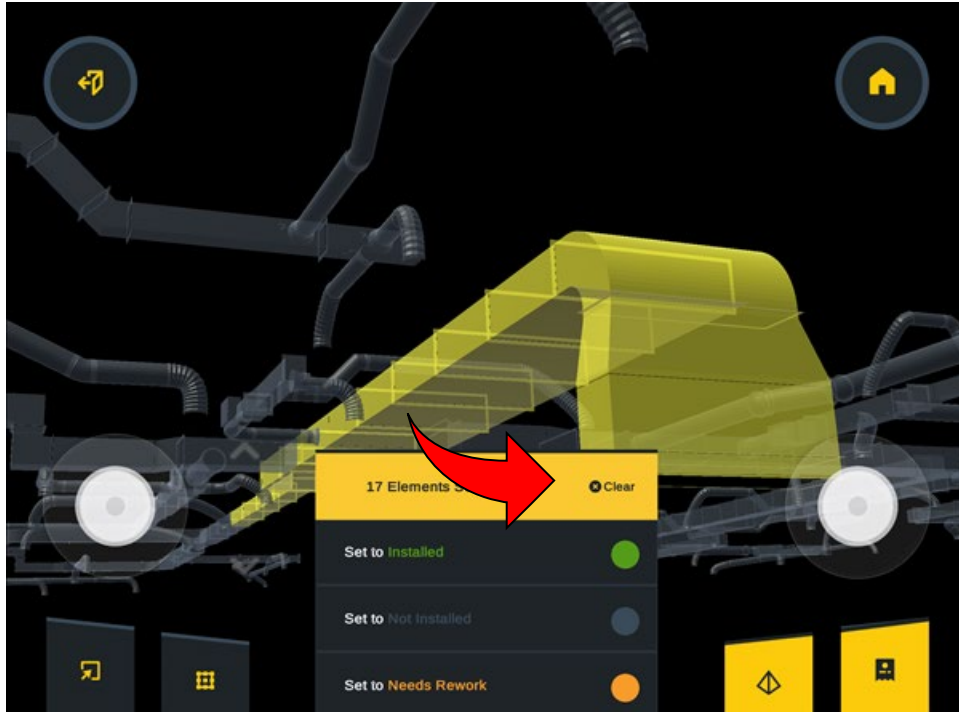

→ To exit “Selection Setting Options” dialogue box, tap on the “Clear” button.

 Clear

Once the status is applied the model elements will change color to signify the status of the element

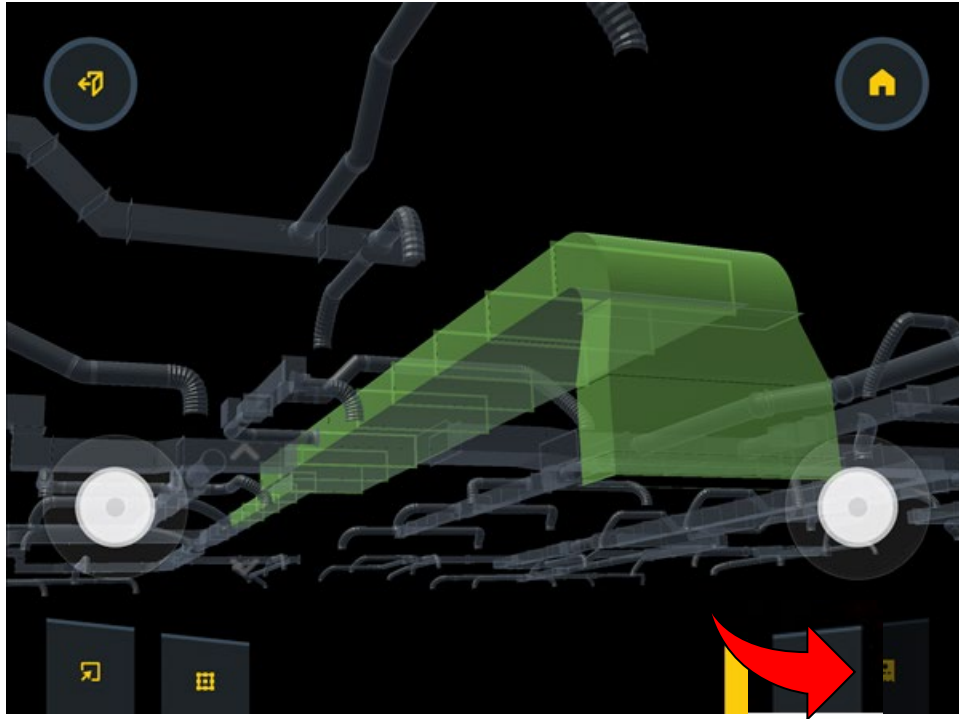

### Properties button



On the lower right of the screen there is the “Properties” button.

When an element is selected, and the properties button is selected, quick reference data will pop up in the lower middle of the screen.

The typical properties are Size, Name, System, Length, Weight.

→ When finished, you can exit the viewing screen by selecting the “Exit Model View” button on the top left of the screen.

